

Odor Removal Filter

Series AMF

Series AMF Odor Removal Filter efficiently removes odor in compressed air with an activated carbon element.

The unit is designed for use in food processing, pharmaceutical, brewing and breathing systems where odors must be removed.

Removes odor and gas ingredients in compressed air.

Activated carbon element with large filtration area (1420 m²/g)

Easy replacement of elements



JIS Symbol

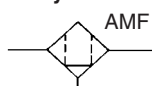

Model

Model	AMF150	AMF250	AMF350	AMF450	AMF550	AMF650	AMF850
Rated flow (ℓ/min (ANR)) <small>Note)</small>	200	500	1000	2000	3500	6000	12000
Port size (Nominal size B)	1/8, 1/4, 3/8	1/4, 3/8, 1/2	3/8, 1/2, 3/4	1/2, 3/4, 1	3/4, 1	1, 1 1/2	1 1/2, 2
Weight (kg)	0.38	0.55	0.9	1.4	2.1	4.2	10.5

 Note) Max. flow capacity at a pressure of 0.7 MPa. Max. flow varies depending on operating pressure. Refer to "Flow Characteristics" (page 14-20-44) and figure of "Max. Air Flow" (page 14-20-45).

Model/Self-standing Type

Model	AMF800	AMF900	AMF1000
Rated flow (ℓ/min (ANR))	8000	24000	40000
Port size (Nominal size B)	2 ^ø flange	2 ^ø , 3 ^ø , 4 ^ø flange	4 ^ø , 6 ^ø flange
Weight (kg)	90	200	410

Model/Piping Support Type

Model	AMF801	AMF901
Rated flow (ℓ/min (ANR))	8000	24000
Port size (Nominal size B)	2 ^ø flange	2 ^ø , 3 ^ø , 4 ^ø flange
Weight (kg)	40	120

Specifications

Fluid	Compressed air
Max. operating pressure	1.0 MPa
Min. operating pressure	0.05 MPa
Proof pressure	1.5 MPa
Ambient and fluid temperature	5 to 60°C
Filtration	0.01 μm (95% particle size collection)
Oil mist removal rate	Less than 3.5 particles 0.3 μm or larger per liter of air (100 particles or less per cubic foot) Series "AME" should be installed on the inlet side.)



Please refer to "Made to Order Specifications" on page 14-20-57.

Accessory (Option)

Applicable model	AMF150	AMF250	AMF350	AMF450	AMF550	AMF650	AMF850
Bracket assembly (With cap bolt and spring washer)	BM51	BM52	BM53	BM54	BM55	BM56	BM57

⚠ Caution

Be sure to read before handling. Refer to pages 14-21-3 to 4 for Safety Instructions and Common Precautions on the products mentioned in this catalog, and refer to pages 14-14-6 to 8 for Precautions on every series, and pages 14-20-62 to 64 for more detailed precautions on every series.

How to Order

AMF150 to AMF850

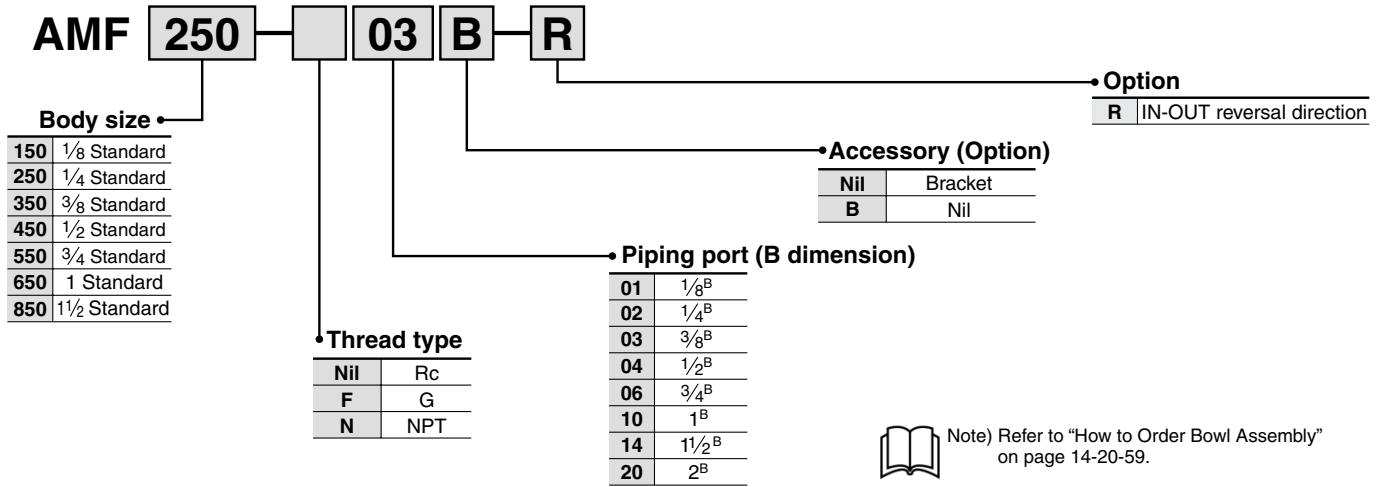

Self-standing type AMF800 to AMF1000

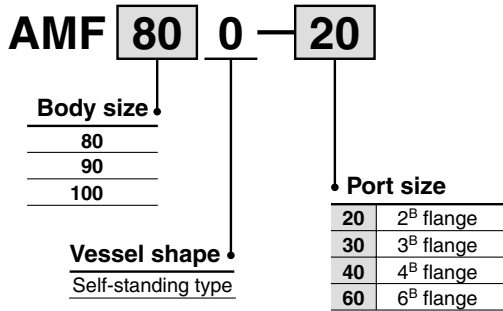

Piping Support type AMF801/901

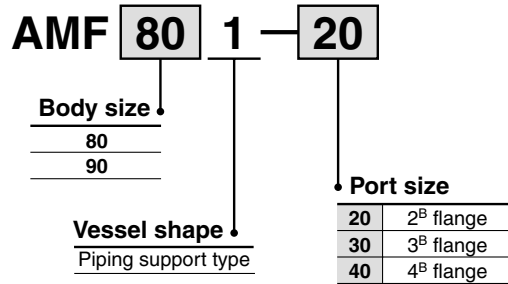

Model Selection

Select the model in accordance with the following procedure taking the inlet pressure and max. air flow into consideration.

(Example) Inlet pressure: 0.6 MPa

Max. air flow capacity: 5 m³/min (ANR)

1. Select the point of contact A of inlet pressure and max. air capacity in the graph.
2. AMF650 is obtained when the max. flow line is above the point of intersection A in the graph.



Note) Make sure to select a model that has the maximum flow rate line above the obtained intersecting point. With a model that has the maximum flow rate line below the obtained intersecting point, the flow rate will be exceeded, thus leading to a problem such as being unable to satisfy the specifications.

Max. Air Flow

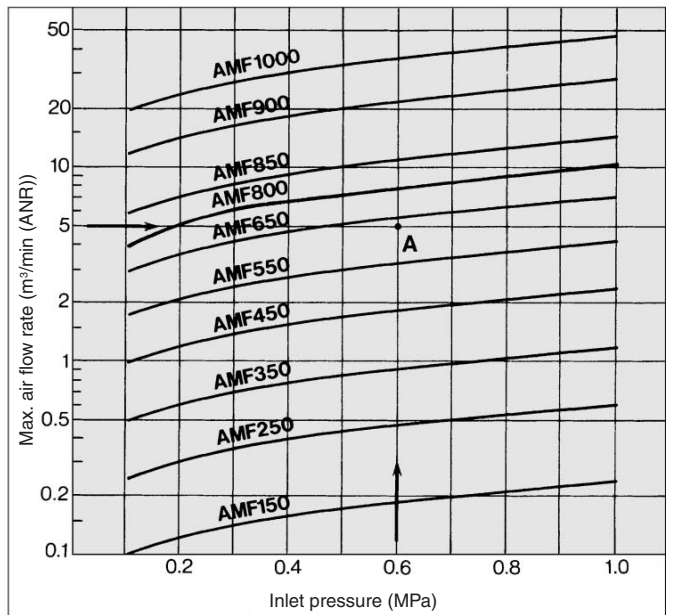

- HA
- AT
- ID
- AMG
- AFF
- AM
- Misc.

Series AMF

Flow Characteristics/Refer to "How to Select" on page 14-20-43 regarding model selection. ————— Element initial condition



Note) Compressed air over max. flow line in the table below may not meet the specifications of the product. It may cause damage to the element.

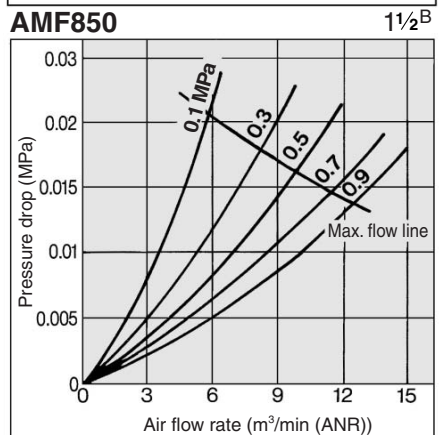
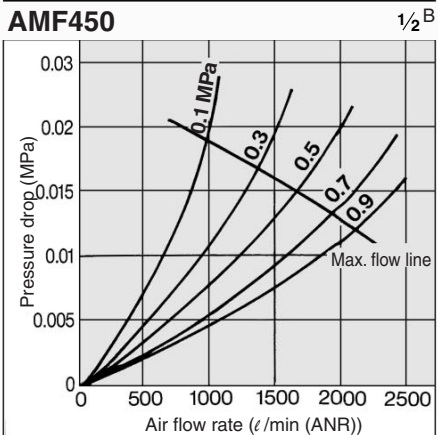
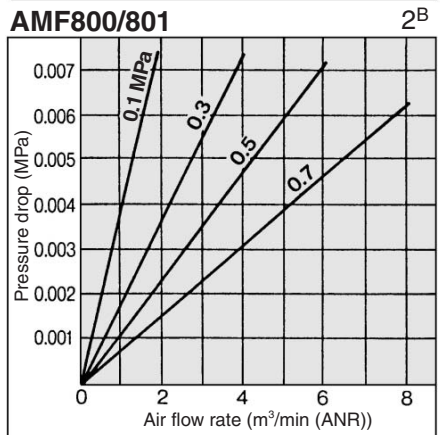
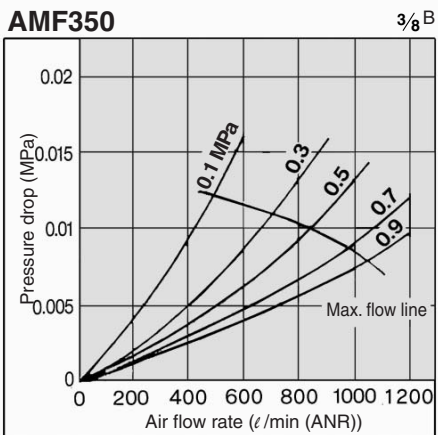
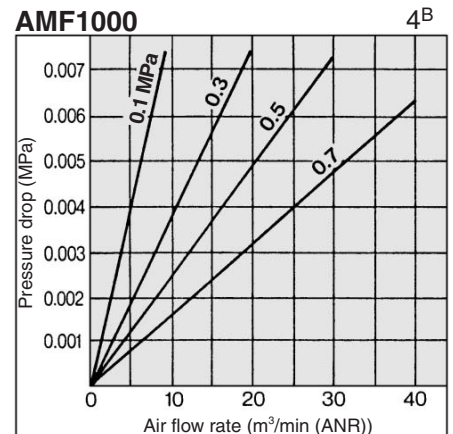
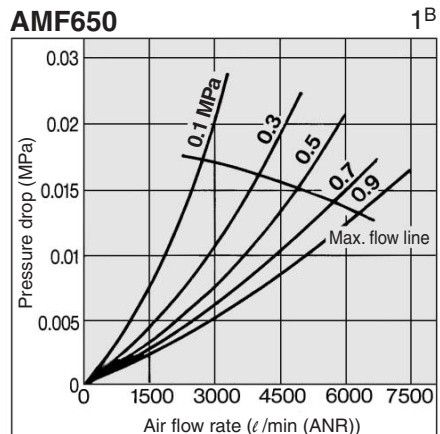
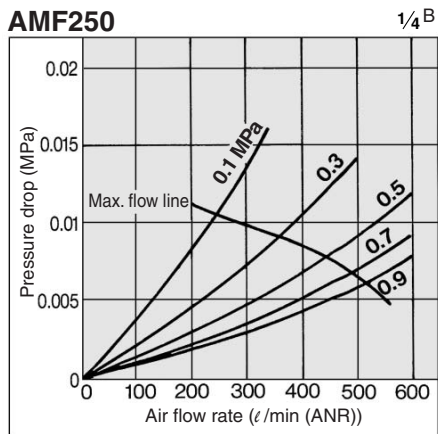
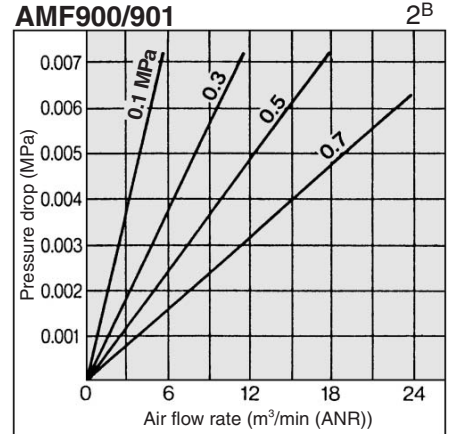
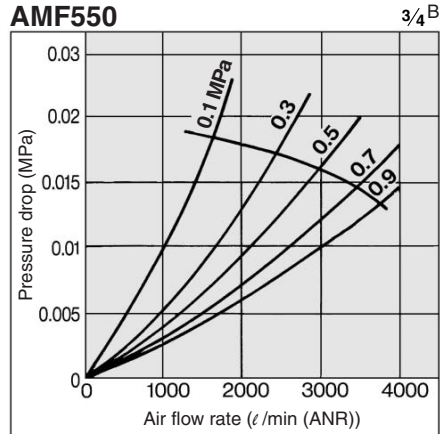
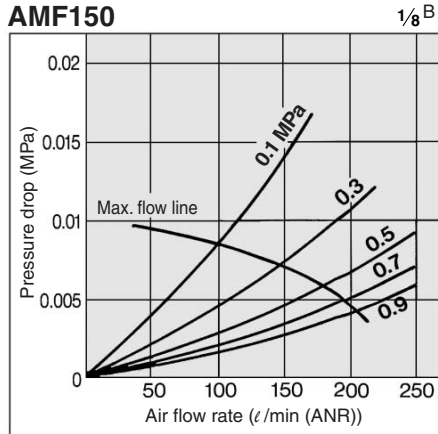

Construction

AMF150 to AMF850

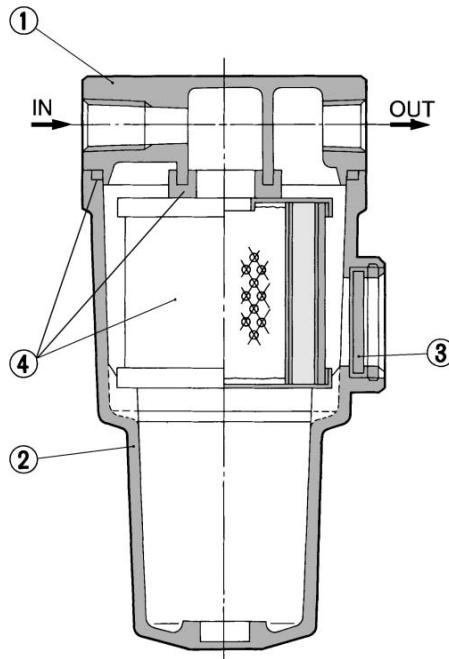

Component parts

No.	Description	Material	Note
①	Body	Aluminum die-casted	Chrome treated
②	Housing	Aluminum die-casted*	Epoxy coating on inner surface
③	Sight glass	Tempered glass	—



Note: Refer to page 14-20-59 for "How to Order Bowl Assembly".



Note: Sight glass is indicated in the figure above for easy understanding of parts, however mounting position is different. Refer to dimensions on pages 14-20-46 to 14-20-47 for details.

Replacement Parts

* AMF850 is aluminum casted.

No.	Description	Material	Model						
			AMF150	AMF250	AMF350	AMF450	AMF550	AMF650	AMF850
④	Element assembly	Glass fiber, Others	AMF-EL150	AMF-EL250	AMF-EL350	AMF-EL450	AMF-EL550	AMF-EL650	AMF-EL850

* Element assembly: With gasket and O-ring

AMF800 to 1000

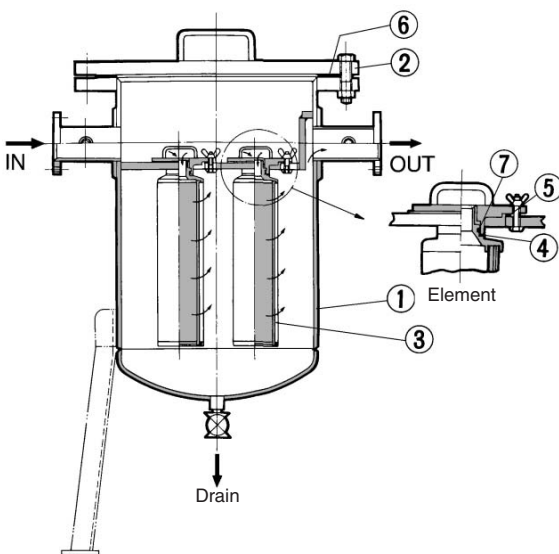

Component Parts

No.	Description	Model		Note
		AMF800/900/1000	AMF801/901	
①	Filter case	SGP-E: SS400	SGP-E: SS400	
②	Cover	SS400	SGP-E: SS400	

Replacement Parts

No.	Description	Material	Model				
			AMF800	AMF801	AMF900	AMF901	AMF1000
③	Element	—	63271	63271	63271 3 pcs.	63271 3 pcs.	63271 5 pcs.
④	Packing	NBR	63148	63148	63148 3 pcs.	63148 3 pcs.	63148 5 pcs.
⑤	Packing	NBR	O.D.112 x I.D.90 x T3 1 pc.	—	O.D.112 x I.D.90 x T3 3 pcs.	—	O.D.112 x I.D.90 x T3 5 pcs.
⑥	Gasket	V#6500	AL-61S	AL-60S	AL-63S 3 pcs.	AL-62S	AL-31S
⑦	O-ring	NBR	JIS B 2401G35 1 pc.	JIS B 2401G35 1 pc.	JIS B 2401G35 3 pcs.	JIS B 2401G35 3 pcs.	JIS B 2401G35 5 pcs.

HA

AT

ID

AMG

AFF

AM

Misc.

Series AMF

AMF150 to AMF350 Dimensions

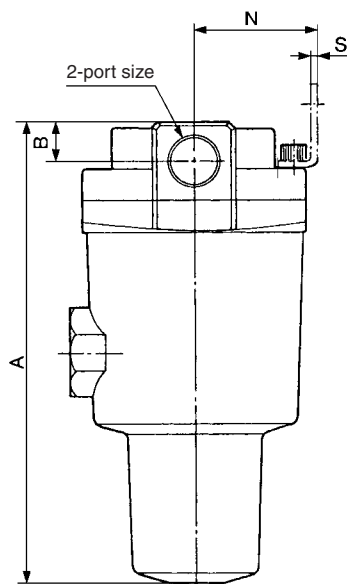
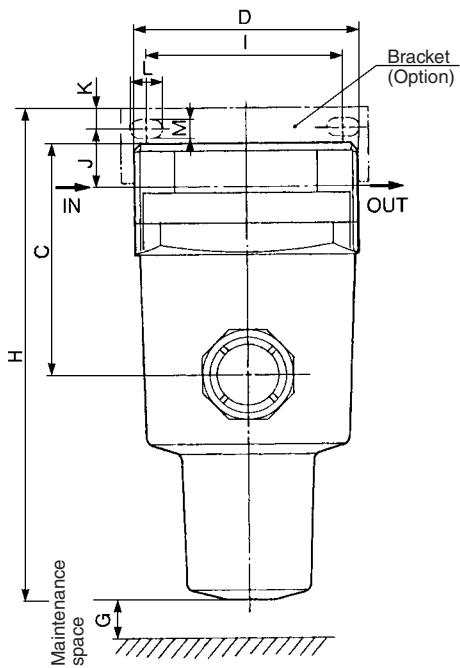
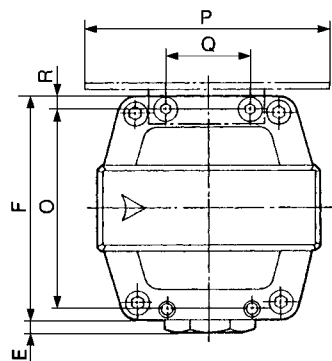

Model	Port size (Nominal size B)	A	B	C	D	E	F	G	Dimensions with mounting bracket											
									H	I	J	K	L	M	N	O	P	Q	R	S
AMF150	1/8, 1/4, 3/8	139	13	55	63	7.5	63	10	146	56	15	5	9	5.5	35	54	70	26	4.5	1.6
	1/4, 3/8	152	13	66	76	4	76	10	167	66	20	8	12	6	40	66	84	28	5	2.0
AMF250	1/2	158	16	72	76	4	76	10	167	66	17	8	12	6	40	66	84	28	5	2.0
	3/8, 1/2	184	16	92	90	5	90	10	198	80	22	8	14	7	50	80	100	34	5	2.3
AMF350	3/4	190	19	98	90	5	90	10	198	80	19	8	14	7	50	80	100	34	5	2.3

AMF450 to AMF850 Dimensions

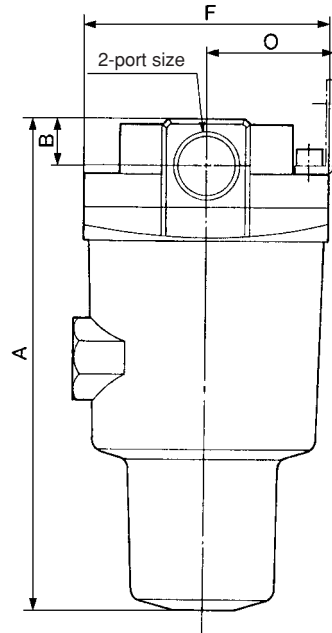
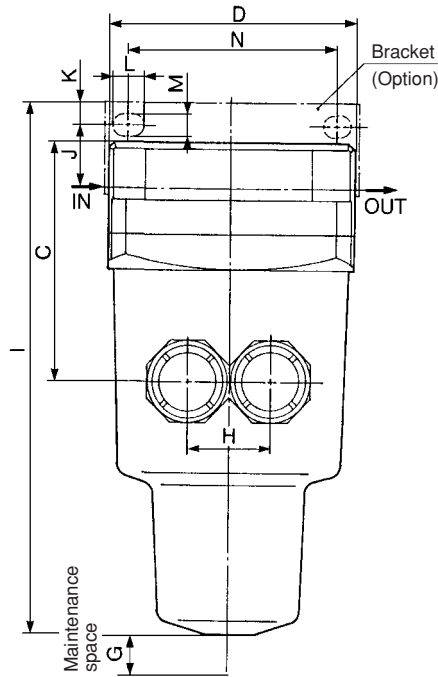
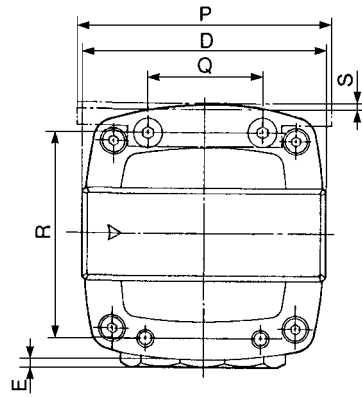

Model	Port size (Nominal size B)	A	B	C	D	E	F	G	H	Dimensions with mounting bracket										
										I	J	K	L	M	N	O	P	Q	R	S
AMF450	1/2, 3/4	205	19	100	106	3	106	10	36	221	25	10	14	9	90	55	110	50	88	3.2
	1	212	22	107	106	3	106	10	36	221	21	10	14	9	90	55	110	50	88	3.2
AMF550	3/4, 1	239	22	128	122	3	122	10	44	257	30	10	16	9	100	65	130	60	102	4.5
AMF650	1, 1 1/2	291	32	167	160	—	160	10	66	314	40	15	20	11	150	85	180	76	136	4.5
AMF850	1 1/2, 2	403	42	235	220	—	220	10	96	406	30	15	24	13	180	120	220	110	184	6

HA

AT

ID

AMG

AFF

AM

Misc.

Series AMF

AMF801/901/800/900/1000 Dimensions

AMF801/901

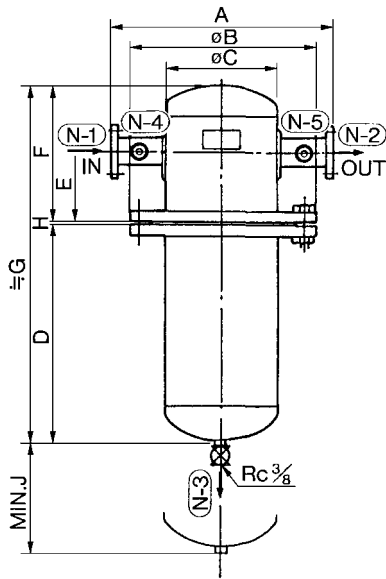

ORIENTATION

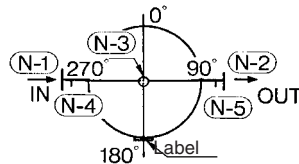

Model	Connection (Flange)	A	øB	øC	D	E	F	G	H	J
AMF801	2 ^B	400	280	6B	550	150	270	823	3	797
AMF901	2 ^B , 3 ^B , 4 ^B	620	445	12B	570	300	520	1093	3	867

AMF800/900/1000

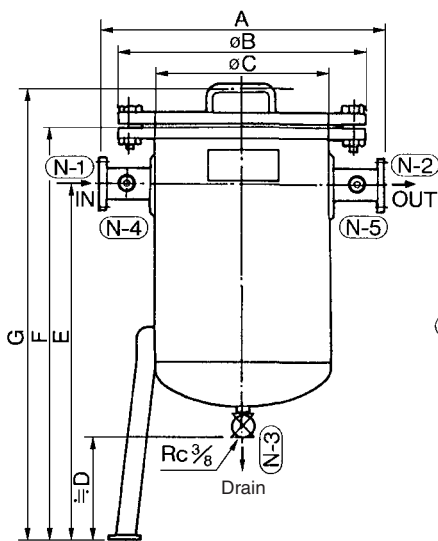

ORIENTATION

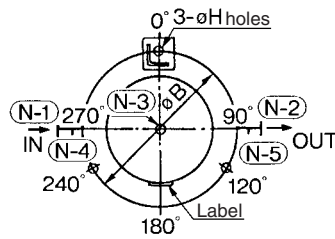

Model	Connection (Flange)	A	øB	øC	D	E	F	G	H	Anchor bolt
AMF800	2 ^B	500	330	8 ^B	300	1070	1200	1290	20	M16 x 400
AMF900	2 ^B , 3 ^B , 4 ^B	720	560	400	300	1070	1230	1335	24	M20 x 500
AMF1000	4 ^B , 6 ^B	870	745	550	300	1090	1320	1450	24	M20 x 500